

**OPERATOR'S MANUAL  
 TECHNICAL SUPPLEMENT  
 PARTS AND ELECTRICAL DIAGRAMS**



# Donut Glazer

**HG18EZ • HG24EZ • HG18C • HG24C**

**ITEM NUMBERS**

- |  |   |  |  |
|--|---|--|--|
| <input type="checkbox"/> <b>22528</b> HG18C  | <input type="checkbox"/> <b>22530</b> HG18EZ    | <input type="checkbox"/> <b>22569-1</b> HG18EZ | <input type="checkbox"/> <b>22536</b> HG24EZ   |
| <input type="checkbox"/> <b>22529</b> HG18EZ | <input type="checkbox"/> <b>22569</b> HG18EZ 24 | <input type="checkbox"/> <b>22534</b> HG24C    | <input type="checkbox"/> <span style="border: 1px solid black; display: inline-block; width: 100px; height: 20px;"></span> (Other) |

**SERIAL NUMBER**

*Item Number / Serial Number are listed on a data tag attached to the equipment.  
 This manual should only be used with the Item Number(s) shown above.*





## *Owner's Manual*

# Donut Glazers

## HG18-HG24 Series

HG18EZ • HG18C • HG24EZ • HG24C

Belshaw-Adamatic Bakery Group  
814 44<sup>TH</sup> ST NW, Suite 103  
Auburn, WA 98001 USA

Phone: 1-800-BELSHAW ■ 800-578-2547 ■ (+1)206-322-5474  
Email: [service@belshaw.com](mailto:service@belshaw.com) ■ [www.belshaw.com](http://www.belshaw.com)

## **BELSHAW-ADAMATIC FREIGHT DAMAGE POLICY**

Belshaw-Adamatic has made every effort to ensure that your equipment arrives in excellent condition. **For your protection**, please inspect your shipment for any signs of damage that may have occurred during transport. Please note any damage that is found during inspection and file a freight claim with the shipping company immediately. Acceptance of damaged equipment may become the responsibility of the acceptor.

## **IMPORTANT**

Keep This Manual For Future Reference.



### **EQUIPMENT RECORD**

**Please provide the information below when you correspond with us about your machine.**

Purchased by \_\_\_\_\_

Installed by \_\_\_\_\_

Date of installation \_\_\_\_\_ Model number \_\_\_\_\_

Serial number \_\_\_\_\_

**072817**

**MN-1744**

**Belshaw-Adamatic Bakery Group**

**814 44th Street NW, Suite 103**

**Auburn, WA 98001 USA**

**Phone: 1-800-BELSHAW ■ 800-578-2547 ■ (+1)206-322-5474**

**Email: [service@belshaw.com](mailto:service@belshaw.com) ■ [www.belshaw.com](http://www.belshaw.com)**

# Contents

<b>ABOUT THE HG18-HG24 SERIES GLAZERS</b> .....	<b>4</b>
<b>1 ASSEMBLY – HG18EZ</b> .....	<b>5</b>
INITIAL CLEANING AND SANITATION .....	5
ASSEMBLING THE GLAZER .....	5
<b>2 ASSEMBLY – HG24EZ</b> .....	<b>7</b>
INITIAL CLEANING AND SANITATION .....	7
ASSEMBLING THE GLAZER .....	7
<b>3 ASSEMBLY – HG18C/HG24C</b> .....	<b>9</b>
INITIAL CLEANING AND SANITATION .....	9
ASSEMBLING THE GLAZER .....	9
<b>4 ASSEMBLY – KETTLE COVER AND DRAIN TRAY (OPTIONAL)</b> .....	<b>10</b>
INSTALLING THE KETTLE COVER (OPTIONAL) .....	10
INSTALLING THE DRAIN TRAY (OPTIONAL) .....	10
<b>5 OPERATION – HG18EZ/HG24EZ</b> .....	<b>12</b>
GENERAL USE OF THE GLAZER .....	12
OPERATING THE GLAZER .....	12
<b>6 OPERATION – HG18C/HG24C</b> .....	<b>14</b>
GENERAL USE OF THE GLAZER .....	14
OPERATING THE GLAZER .....	14
<b>7 CLEANING</b> .....	<b>15</b>
CLEANING THE GLAZER .....	15
<b>8 MAINTENANCE</b> .....	<b>16</b>
<b>9 PARTS LISTS</b> .....	<b>16</b>

# About the HG18-HG24 Series Glazers

The **HG18-HG24 Series** glazers are designed to glaze donuts on the top and sides with an even distribution of glaze.

- **HG18EZ and HG24EZ Glazers** use the EZLift rail system. The glaze applicator slides on a frame above the glazer.
- **HG18C and HG24C Glazers** have no frame. The glaze applicator is held directly by the operator.

The **HG18-HG24 Series Glazers** are designed to be used on a level floor.

The **HG18-HG24 Series Glazers** produce 0.0 dB(A) of equivalent A-weighted sound pressure at workstations. This has been determined because there is no machine-driven operation. Operation of the **HG18-HG24 Series Glazers** is by a human operator.

Thorough understanding of how to safely operate, clean, and maintain the **HG18-HG24 Series Glazers** will prevent production delays and injuries. The operator must work safely at all times, read and follow the instructions in this manual, and heed all warnings, including the following:

- ⚠ DO NOT OVERFILL the **Glaze Kettle**. If glaze overflows the **Kettle**, it could cause someone to slip on the floor and be seriously injured.
- ⚠ BE CAREFUL never to get glaze, water, or other materials on the floor. If anything does get spilled on the floor, clean the area immediately. Materials on the floor can cause people to slip or fall, resulting in serious injury or loss of life.
- ⚠ TO AVOID damaging the glazer, never use force to assemble, disassemble, operate, clean, or maintain it.
- ⚠ TO PREVENT damage to the **Kettle**, never scrape it with a metal object. Use only a plastic or rubber bowl scraper.

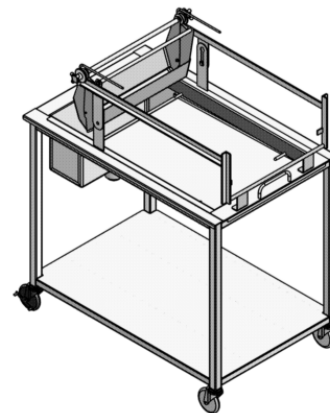

# 1

# Assembly – HG18EZ

## Initial Cleaning and Sanitation

1. REMOVE the **HG18EZ Glazer** from box and discard all packing materials.
2. WASH, RINSE AND SANITIZE all the parts of the **HG18EZ Glazer** before use. (See *Cleaning*, Section 7.)

## Assembling the Glazer

See Figure 1 opposite. Glazer may be partially assembled on delivery.

1. PLACE the **Lower Shelf** (8) onto the bottom of the **Frame** (5).
2. INSERT the **Glazer Kettle** (10) onto the **Frame** (5).
3. PLACE the **Screen Support** (9) onto the **Kettle** (10).
4. INSERT the **Drain Valve** (6) onto the drain under the **Glaze Kettle**. (10).

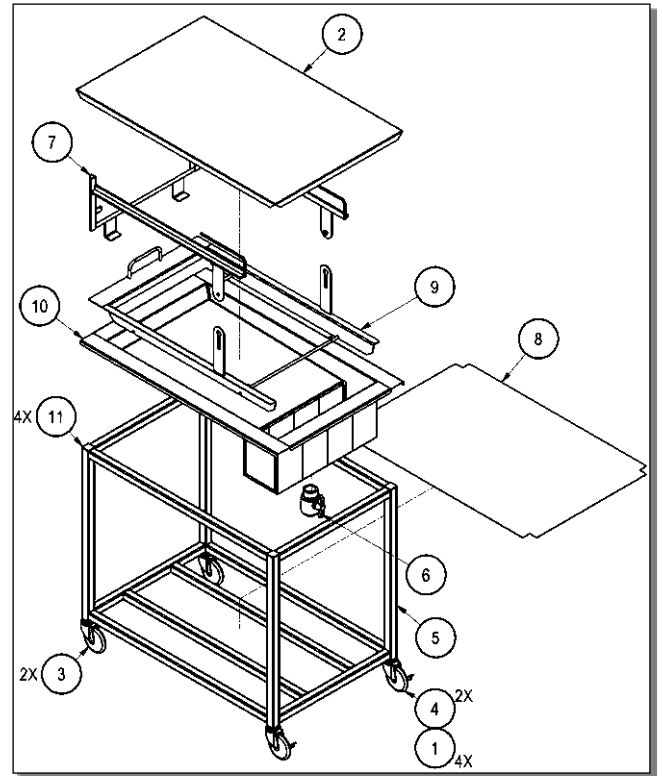

**Figure 1**, HG18EZ Glazer Assembly with box-shaped glaze kettle. (Glazer may have a sloping kettle)

Notes and options:

Your glazer may include:

- **Cover** (2)
- **Lower shelf** (8)
- **Drain Tray** (*not shown*). For assembly instructions, see Section 4
- **Sloping Kettle**: Your glazer may have a sloping **Kettle** (10), rather than a box shaped kettle as shown opposite.

5. ASSEMBLE the **Upper Frame** (7) onto the **Screen Support** (9) by inserting the pin on the **Upper Frame** into the top of the slot on the **Screen Support** and sliding it down. (See Figure 2.)

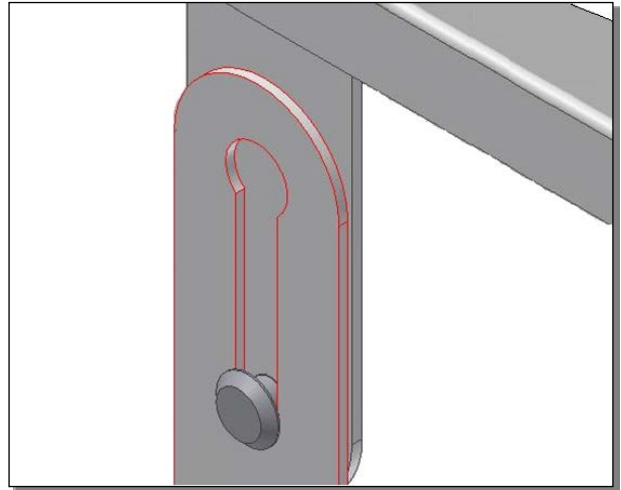

**Figure 2,** Screen Support Slot

6. ASSEMBLE the **Glaze Applicator** onto the top of the **Upper Frame**, aligning the rollers with the tracks (See Figure 3.)

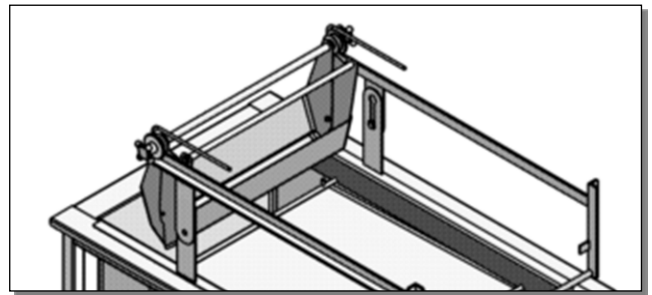

**Figure 3,** Upper Frame Assembly

**Note:** The optional **Glaze Kettle Cover** (2) can be installed onto the kettle after the **Upper Frame** and **Screen Support** are removed. (See Figure 1.)

# 2

# Assembly – HG24EZ

## Initial Cleaning and Sanitation

1. REMOVE the **HG24EZ Glazer** from box and discard all packing materials.
2. WASH, RINSE AND SANITIZE all the parts of the **Glazer** before use. (See *Cleaning*, Section 7.)

## Assembling the Glazer

See Figure 4 opposite. Glazer may be partially assembled on delivery)

3. INSERT the **Glaze Kettle (8)** onto the **Frame (10)**.
4. PLACE the **Screen Support (13)** onto the **Kettle (8)**.
5. INSERT the **Drain Valve (5)** onto the drain under the **Glaze Kettle (8)**.
6. Place the **Drain Tray (9)** over the lip of the **Glaze Kettle (8)**.
7. **Drain Tray (9)** can be placed at side or at end of glazer.

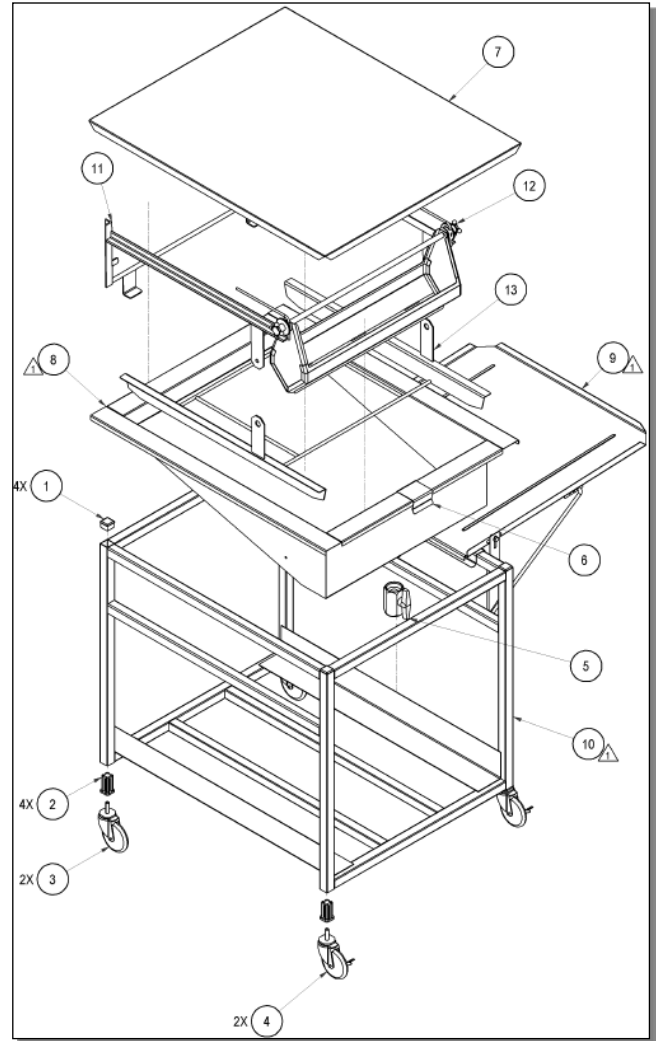
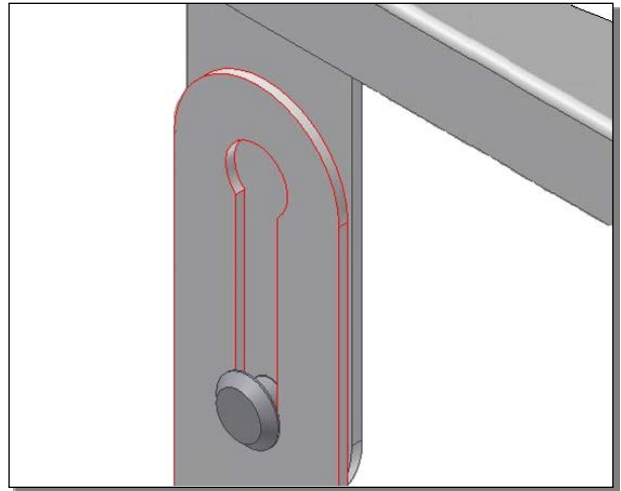

Figure 4, HG24EZ Glazer Assembly



8. ASSEMBLE the **Upper Frame** (11) onto the **Screen Support** (13) by inserting the pin on the **Upper Frame** into the top of the slot on the **Screen Support** and sliding it down. (See Figure 5.)



**Figure 5,** Screen Support Slot

9. ASSEMBLE the **Glaze Applicator** onto the top of the **Upper Frame**, aligning the rollers with the tracks (See Figure 6.)

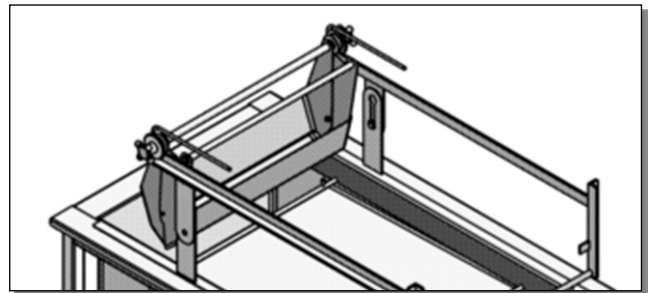

**Figure 6,** Upper Frame Assembly

**Note:** The optional **Glaze Kettle Cover** (7) can be installed onto the kettle after the **Upper Frame** and **Screen Support** are removed. (See Figure 4.)

# 3 Assembly – HG18C/HG24C

## Initial Cleaning and Sanitation

1. REMOVE the **Glazer** from box and discard all packing materials.
2. WASH, RINSE AND SANITIZE all the parts of the **Glazer** before use. (See *Cleaning*, Section 7.)

## Assembling the Glazer

(See Figure 7 opposite.) Glazer may be partially assembled on delivery

1. PLACE the **Lower Shelf** (6) onto the bottom of the **Frame** (9).
2. INSERT the **Glazer Kettle** (12) onto the top of the **Frame** (9).
3. PLACE the **Screen Support** (10) onto the **Kettle** (12).
4. INSERT the **Drain Valve** (11) onto the drain under the **Glaze Kettle** (12).

Notes and options:

Your glazer may include:

- **Cover** (2); **Floor** (8)
- **Drain Tray** (not shown). See Section 4
- **Sloping Kettle:** Your glazer may have a sloping **Kettle** (10), rather than a box shaped kettle as shown opposite.

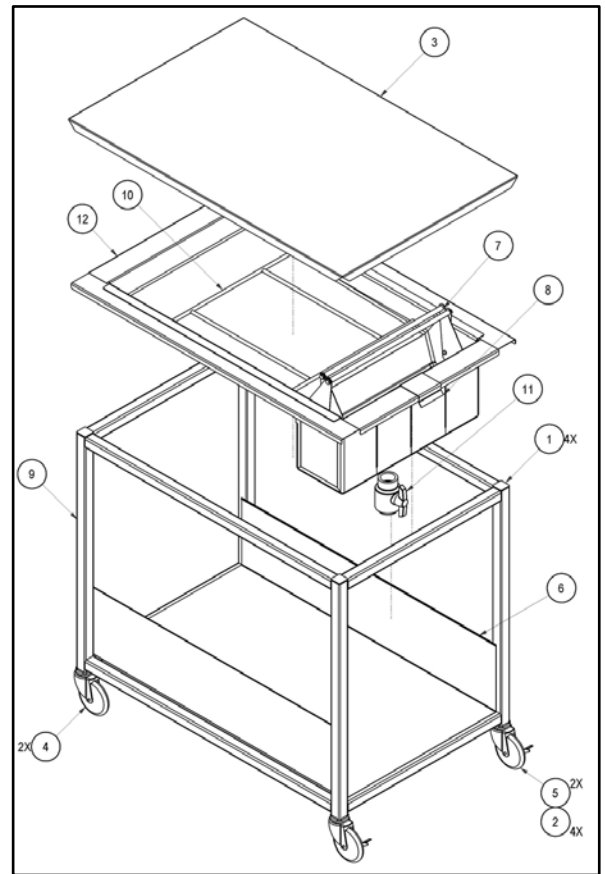
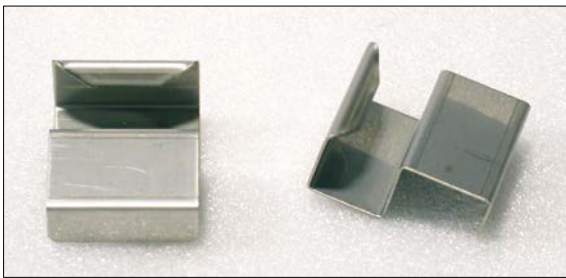

**Figure 7, HG18C/HG24C Glazer Assembly with box-shaped glaze kettle. (Glazer may have a sloping kettle)**

# 4 Assembly – Kettle Cover and Drain Tray (optional)

## Installing the drain tray (optional)

1. Find the Drain Tray support brackets (Figure 8)



**Figure 8,** Drain Tray support brackets

2. Place the Drain Tray support brackets on the lower bar of the frame (Figure 9)



**Figure 9,** Drain Tray support brackets

3. Make sure that the Drain Tray Support Rod is inserted into the Mounting Brackets under the Drain Tray (Figure 10)



**Figure 10,** Brackets under Drain Tray

Install the Drain Tray (Figure 11)



**Figure 11,** Installing the Drain Tray

## Installing the Kettle Cover support brackets (optional, HG18 only)

1. Find the four Cover Support Brackets (Figure 12).

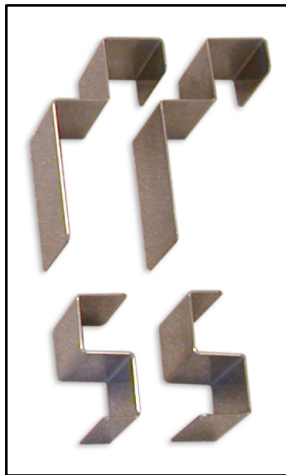

**Figure 12,** Support brackets: Upper (top) and Lower (bottom)

2. Place the Lower Support Brackets on the lower bar of the frame (Figure 13). Place under the bottom shelf if necessary.



**Figure 13,** Kettle Cover support brackets

3. Place the Upper Support Brackets on the upper bar of the frame (Figure 14). Place under the glaze kettle.

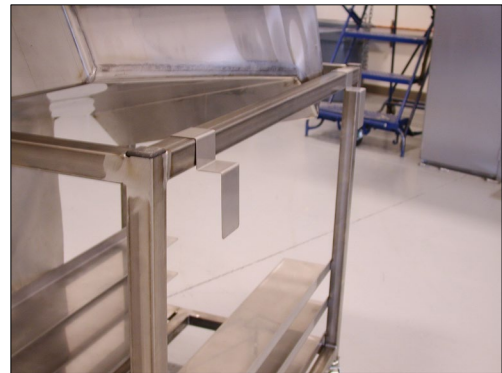

**Figure 14,** Upper support brackets

4. Install the Kettle Cover on the side of the Glazer (Figure 15).

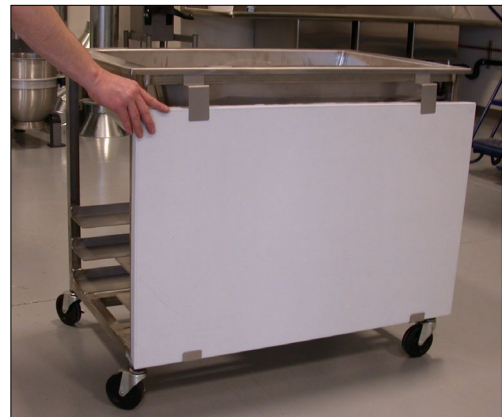

**Figure 15,** Kettle Cover installed on side of glazer

5. Or, place the cover over the top of the Glazer Kettle (Figure 16).



**Figure 16,** Glazer with cover on

# 5 Operation – HG18EZ/HG24EZ

## General Use of the Glazer

To use the **HG18EZ** or **HG24EZ Glazers**, SET a screen of donuts onto the **Screen Support**, then PASS the **Glaze Applicator** over the donuts by the frame-supported applicator on the **Glazer**.

The **Glaze Applicator** is designed to give uniform glaze coverage to donuts. Any excess glaze will drain back into the reservoir.

## Operating the Glazer

1. After the **Glazer** has been cleaned, sanitized and assembled, POUR glaze into the glaze reservoir section of the **Kettle** (Kettle will hold approximately 30 pounds of glaze).
2. TILT the **Upper Frame** assembly up, placing the **Glaze Applicator** into the **Glaze Reservoir** (See Figure 17.)
3. Allow the **Applicator** to FILL with glaze.
4. PLACE a screen of donuts on top of the **Screen Support**, locating it on the pins.
5. SPREAD the **Glaze Applicator** handles apart to close the bottom of the applicator.

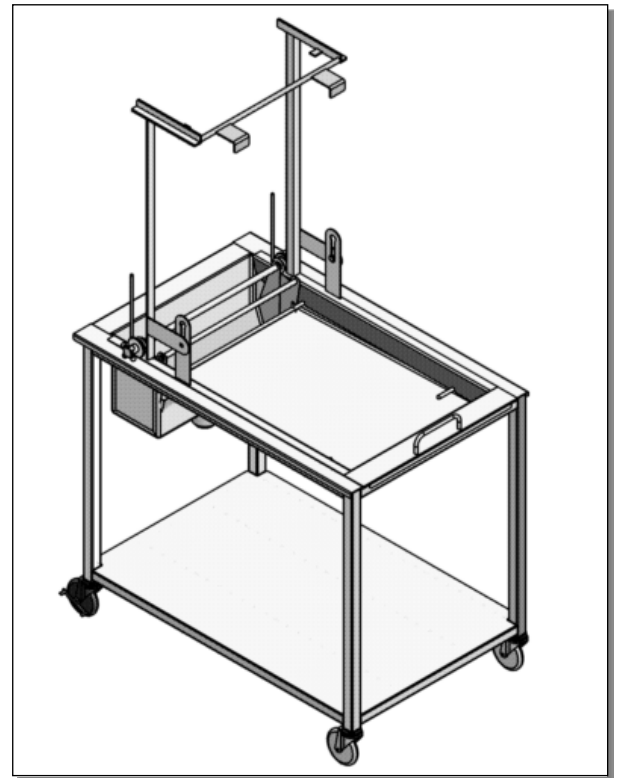
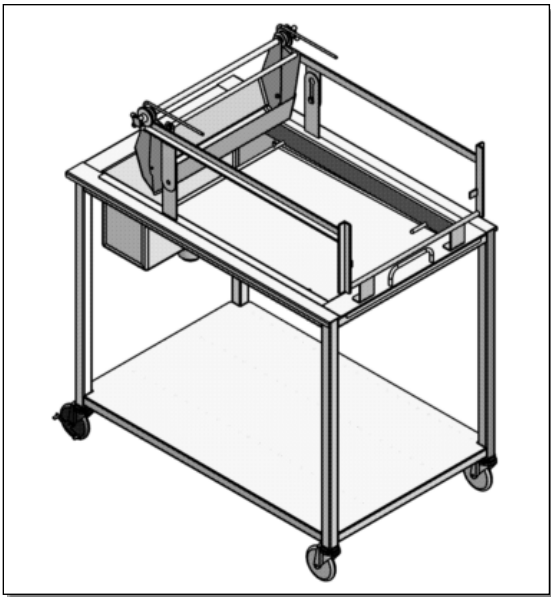

Figure 17, Filling Position

6. TILT the **Upper Frame** assembly down lifting the **Glaze Applicator** out of the **Kettle** (See Figure 18)



**Figure 18,** Tilt Upper Frame Down



**Figure 19,** Glazing Position

7. ROLL the **Glaze Applicator** over the donuts and return it to the reservoir end to the **Kettle**. (See Figure 19.)
8. As it rolls, OPEN or CLOSE the handles of the **Glaze Applicator** to allow glaze to flow evenly over the donuts.
9. TILT the **Upper Frame** assembly up again, placing the **Glaze Applicator** back into the reservoir.
10. REMOVE the screen of donuts and place a new screen on the **Screen Support**.
11. REPEAT steps 2 through 10

### IMPORTANT

Casters with brakes can be locked during operation to keep glazer stationary. DO NOT forget to unlock brakes on wheels after operation, as most bakery floors are very hard on rubber wheels.



# 6 Operation – HG18C/HG24C

## General Use of the Glazer

To use the **HG18C or HG24C Glazer**, PLACE a screen of donuts onto the **Screen Support**, then PASS the **Glaze Applicator** over the donuts by hand. Any excess glaze will drain back into the reservoir.

## Operating the Glazer

1. After the **Glazer** has been cleaned, sanitized and assembled, POUR glaze into the glaze reservoir section of the **Kettle** (Kettle will hold approximately 30 pounds of glaze).
2. PLACE a screen of donuts on top of the **Screen Support** (9), locating it on the pins.
3. LOWER the **Glaze Applicator** (5) by hand into the **Glaze Reservoir** (10).
4. Allow the **Glaze Applicator** (5) to FILL with glaze.
5. MOVE the **Glaze Applicator** over the donuts about 3 inches (75 mm) above them
6. As you move the **Glaze Applicator**, OPEN or CLOSE the handles of the **Glaze Applicator**

to allow glaze to flow evenly over the donuts.

7. Return the **Glaze Applicator** to the reservoir end of the **Kettle**.
8. REMOVE the screen of donuts and place a new screen on the **Screen Support**.
9. REPEAT steps 2 through 8.

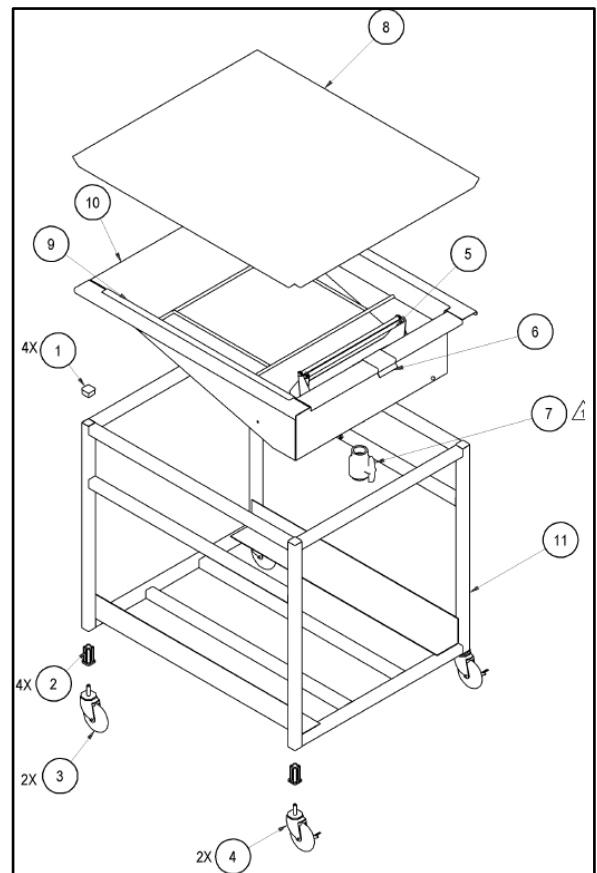

Figure 20, HG18C/HG24C Glazer



## Cleaning the Glazer

For your safety, observe the following warnings throughout the entire cleaning process.

Once a day, clean as explained below:

1. DRAIN/DISCARD unused glaze.
2. REMOVE the following parts from the **Glazer**:
  - ✓ Glaze Applicator
  - ✓ Upper Frame (**EZ** models only)
  - ✓ Screen Support
  - ✓ Kettle
3. WASH each of the above parts with mild soap and hot water then RINSE and SANITIZE.
4. WIPE down the **Frame** with damp cloth with mild soap and hot water and SANITIZE.
5. REASSEMBLE in reverse order. (See Assembly, Sections 1-3)

### IMPORTANT

Casters with brakes can be locked during operation to keep glazer stationary. DO NOT forget to unlock brakes on wheels after operation, as most bakery floors are very hard on rubber wheels.



### WARNING

Thoroughly clean and dry the floor if glaze, water, and/or other materials are spilled. Materials spilled on the floor can cause serious injury or loss of life.





# 8

# Maintenance

In order to ensure the intended and safe operation of the **HG18-HG24 Series Glazers**, follow all procedures and instructions listed in the manual.

# 9

# Parts Lists

(See following pages)

# Parts Diagrams For Hand Glazers

The diagrams for your glazer model are indicated in the table below.

There are 3 diagrams for each glazer, 1-Final assembly, 2-Glaze applicator and 3-Drain Tray

## ABOUT ITEM NUMBERS:

Glazer models are identified by an Item Number. You need your glazer's Item Number to find the correct parts diagrams for your glazer. The Item Number is located on a data tag on the glazer. When the item number is known, it should be checked off on the cover page of this manual, and also in the table below.

<input checked="" type="checkbox"/> MARK FOR YOUR GLAZER	ITEM NUMBER	MODEL	SCREEN SIZE	STANDARD OR EZLIFT APPLICATOR
<input type="checkbox"/>	<b>22528</b>	HG18C	17" x 25"	STANDARD
<input type="checkbox"/>	<b>22529</b>	HG18EZ	17" x 25"	EZLIFT
<input type="checkbox"/>	<b>22530</b>	HG18EZ	17" x 25"	EZLIFT
<input type="checkbox"/>	<b>22569</b>	HG18EZ	17" x 25"	EZLIFT
<input type="checkbox"/>	<b>22569-1</b>	HG18EZ	17" x 25"	EZLIFT
<input type="checkbox"/>	<b>22536</b>	HG24EZ	24" x 24"	EZLIFT
<input type="checkbox"/>	<b>22534</b>	HG24C	24" x 24"	STANDARD

DIAGRAM: HG18-2016

USE ONLY FOR

**MODEL: HG18C**

**ITEM NUMBER: 22528**

TO IDENTIFY MODEL AND ITEM NUMBER, SEE DATA TAG ON GLAZER

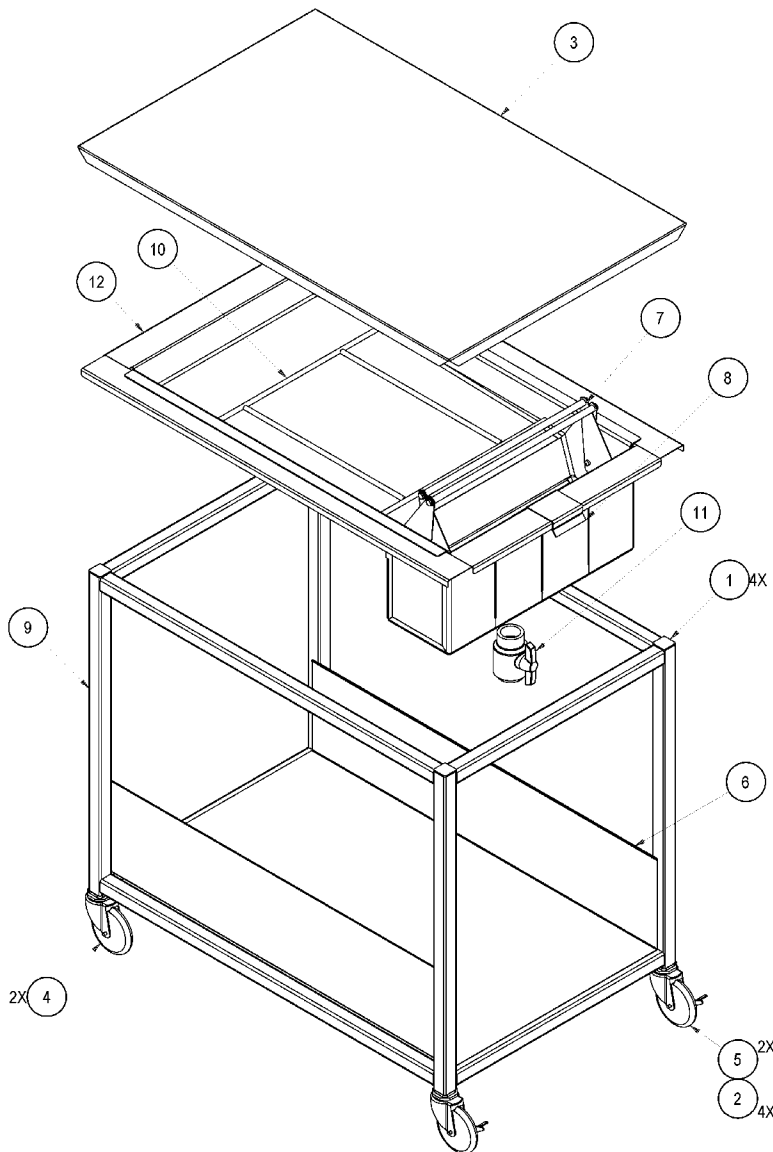

BILL OF MATERIAL			
ITEM	QTY	PART NUMBER	DESCRIPTION
1	4	905-0054-1.25	PLASTIC END CAP 1-1/4 SQ BLK
2	4	FT6-0120	CASTER SOCKET; 18 GA, 1.25, RT-POLY
3	REF	HG18-0020	COVER; KETTLE
4	2	HG18-0031-4	SWIVEL CASTER, 4"
5	2	HG18-0031B-4	SWIVEL CASTER W/BRAKE, 4"
6	1	HG18-0510	BOTTOM TRAY ASSY
7	1	HG18-0527	ASSY; GLAZE APPLICATOR
8	1	HG18-7011	GLAZE DIVERTER
9	1	HG18-8001	FRAME
10	1	HG18-8002	SUPPORT, SCREEN
11	1	HG18-9001	LOW- PRESSURE CPVC BALL VALVE
12	1	HG18EZ-8019	WLDT, KETTLE, 2-PIECE

DIAGRAM: HG18EZ-2012 / HG18EZ-2013

USE ONLY FOR

**MODEL: HG18EZ**

**ITEM NUMBERS: 22529, 22530**

TO IDENTIFY MODEL AND ITEM NUMBER, SEE DATA TAG ON GLAZER

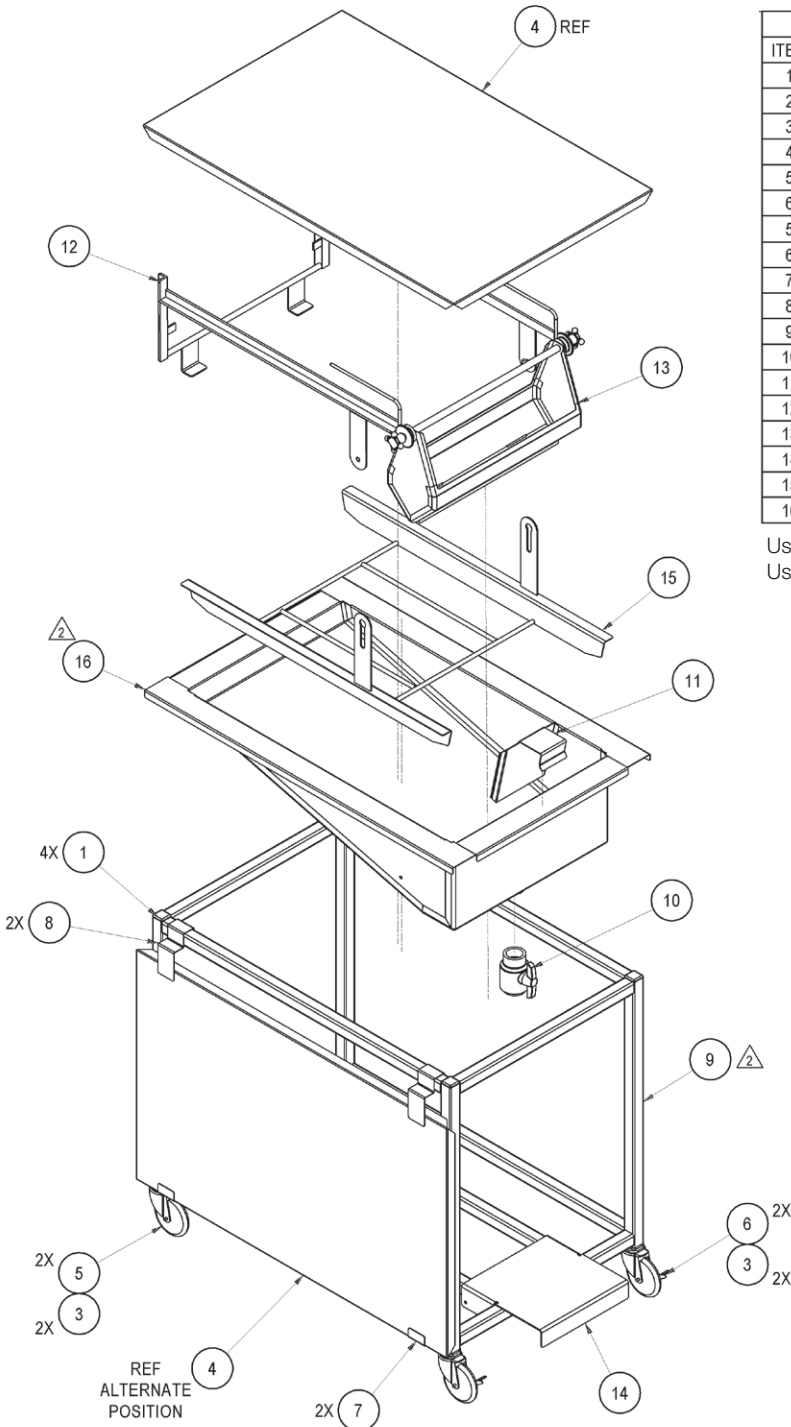

BILL OF MATERIAL			
ITEM	QTY	PART NUMBER	DESCRIPTION
1	4	905-0054-1.25	PLASTIC END CAP 1-1/4 SQ BLK
2	2	C2000G-9000	UNTHREADED SPACER, SS 1/2" OD, 9/16" L, 1/4" SCREW
3	4	FT6-0120	CASTER SOCKET; 18 GA, 1.25, RT-POLY
4	REF	HG18-0020	COVER; KETTLE
5A	2	HG18-0031-4	SWIVEL CASTER, 4"
6A	2	HG18-0031B-4	SWIVEL CASTER W/BRAKE, 4"
5B	2	CSTR-9003	SWIVEL CASTER, 2" (DOUBLE WHEEL)
6B	2	CSTR-9004	SWIVEL CASTER W/BRAKE, 2" (DOUBLE WHEEL)
7	2	HG18-7000	CLIP, COVER STORAGE, BOTTOM
8	2	HG18-7001	CLIP, COVER STORAGE, TOP
9	1	HG18-8001	FRAME
10	1	HG18-9001	LOW-PRESSURE CPVC BALL VALVE
11	1	HG18EZ-0042	GLAZE DIVERTER
12	1	HG18EZ-0535	FRAME, UPPER
13	1	HG18EZ-1004	GLAZE APPL ASSY W/ANGLE GATE 11/32"
14	1	HG18EZ-7006	SUPPORT, BUCKET
15	1	HG18EZ-8005	SUPPORT, SCREEN
16	1	HG18EZ-8017	GLAZE KETTLE WELDMENT

Use 5A and 6A for 22529  
Use 5B and 6B for 22530

DIAGRAM: HG18EZ-2012 / HG18EZ-2013

USE ONLY FOR

**MODEL: HG18EZ**

**ITEM NUMBERS: 22569, 22569-1**

TO IDENTIFY MODEL AND ITEM NUMBER, SEE DATA TAG ON GLAZER

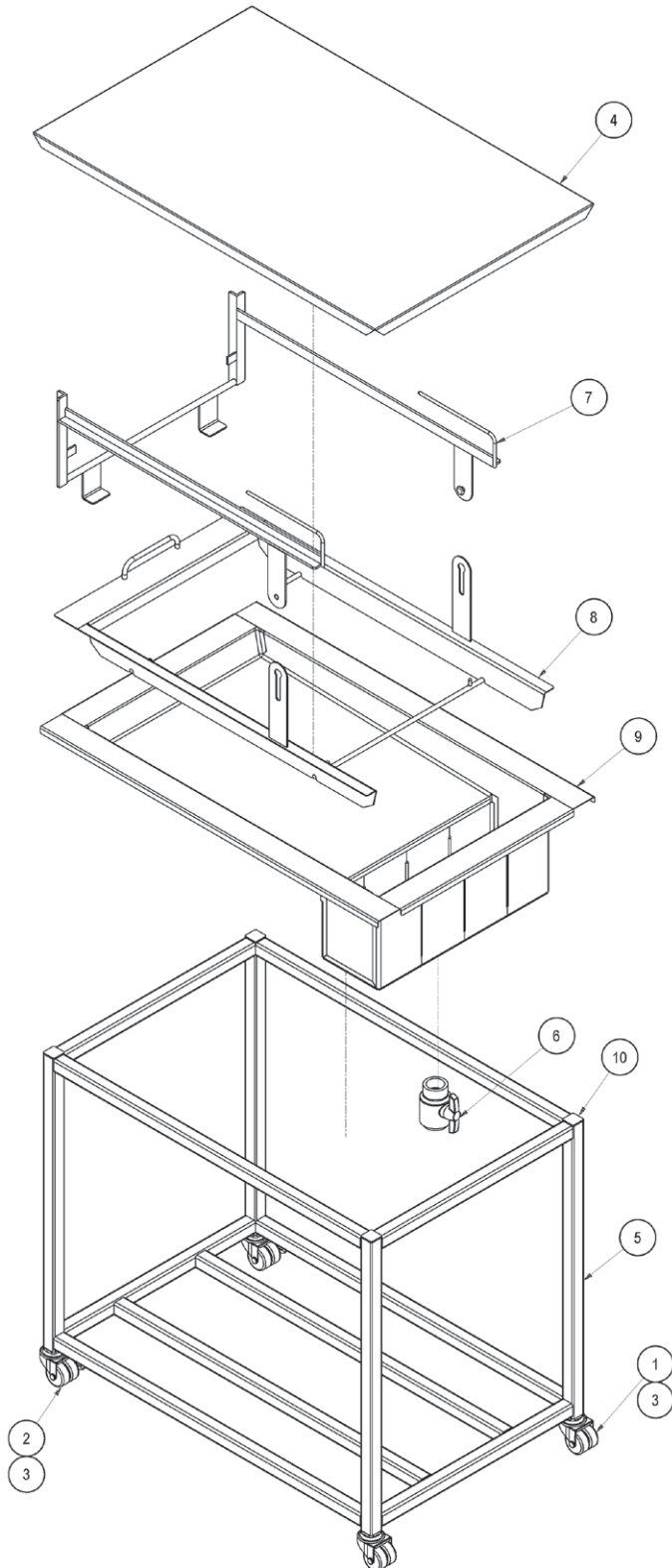

BILL OF MATERIAL			
ITEM	QTY	PART NUMBER	DESCRIPTION
1A	2	CSTR-9003	SWIVEL CASTER, DUAL WHEEL, 2"
2A	2	CSTR-9004	SWIVEL CASTER, DUAL WHEEL, 2", W/BRAKE
1B	2	HG18-0031-4	SWIVEL CASTER, 4"
2B	2	HG18-0031-B4	SWIVEL CASTER, 4", W/BRAKE
3	4	FT6-0120	CASTER SOCKET; 18 GA, 1.25, RT-POLY
4	REF	HG18-0020	COVER; KETTLE
5	1	HG18-8001	FRAME
6	1	HG18-9001	LOW- PRESSURE CPVC BALL VALVE
7	1	HG18EZ-0535	FRAME, UPPER
8	1	HG18EZ-8018	SUPPORT, SCREEN
9	1	HG18EZ-8019	WLDT, KETTLE, 2-PIECE
10	4	905-0054-1.25	PLASTIC END CAP 1-1/4 SQ BLK

Use 1A and 2A for 22569-1

Use 1B and 2B for 22569

DIAGRAM: HG18EZ-2012 / HG18EZ-2013

USE ONLY FOR

**MODEL: HG18EZ**

**ITEM NUMBERS: 22536**

TO IDENTIFY MODEL AND ITEM NUMBER, SEE DATA TAG ON GLAZER

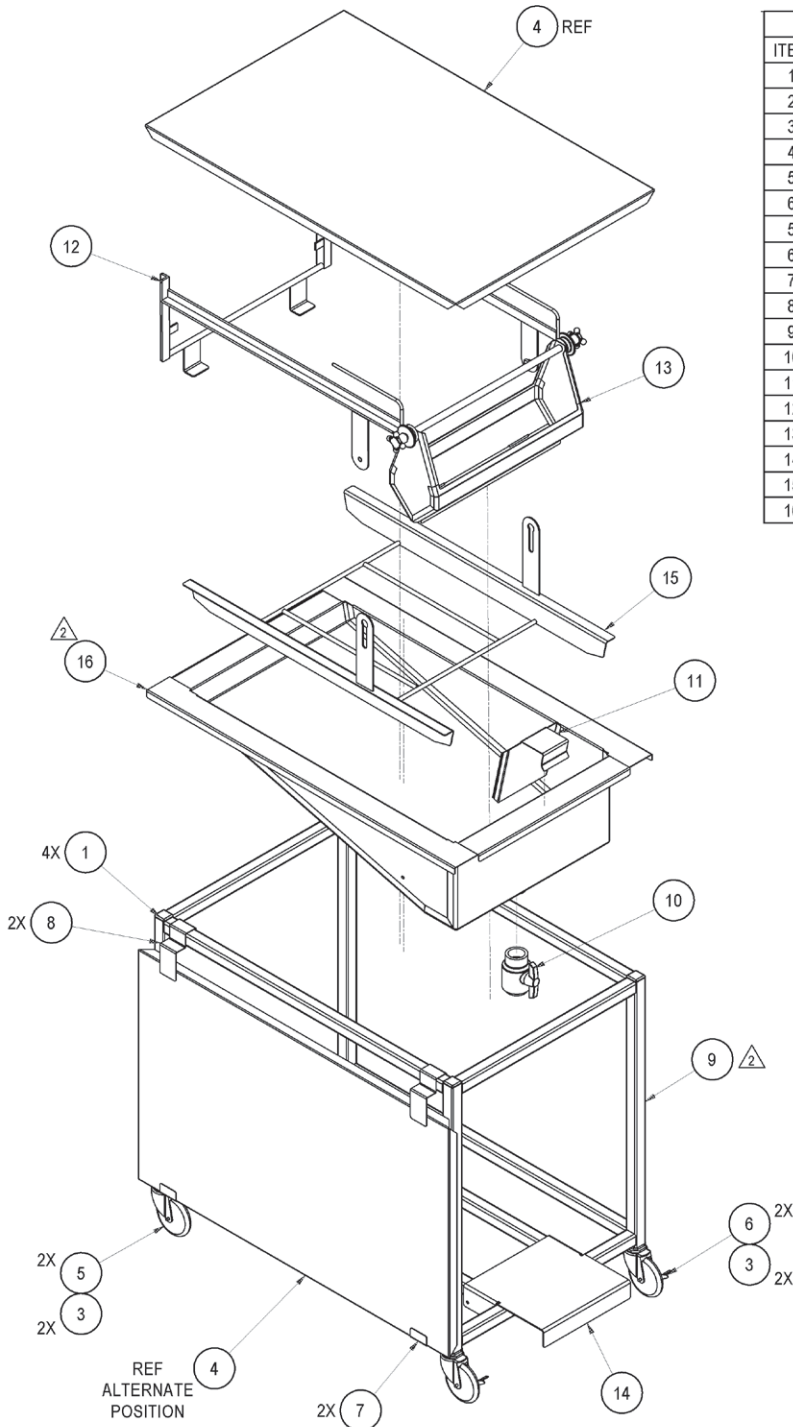

BILL OF MATERIAL			
ITEM	QTY	PART NUMBER	DESCRIPTION
1	4	905-0054-1.25	PLASTIC END CAP 1-1/4 SQ BLK
2	2	C2000G-9000	UNTHREADED SPACER, SS 1/2" OD, 9/16" L, 1/4" SCREW
3	4	FT6-0120	CASTER SOCKET; 18 GA, 1.25, RT-POLY
4	REF	HG18-0020	COVER; KETTLE
5A	2	HG18-0031-4	SWIVEL CASTER, 4"
6A	2	HG18-0031B-4	SWIVEL CASTER W/BRAKE, 4"
5B	2	CSTR-9003	SWIVEL CASTER, 2" (DOUBLE WHEEL)
6B	2	CSTR-9004	SWIVEL CASTER W/BRAKE, 2" (DOUBLE WHEEL)
7	2	HG18-7000	CLIP, COVER STORAGE, BOTTOM
8	2	HG18-7001	CLIP, COVER STORAGE, TOP
9	1	HG18-8001	FRAME
10	1	HG18-9001	LOW-PRESSURE CPVC BALL VALVE
11	1	HG18EZ-0042	GLAZE DIVERTER
12	1	HG18EZ-0535	FRAME, UPPER
13	1	HG18EZ-1004	GLAZE APPL ASSY W/ANGLE GATE 11/32"
14	1	HG18EZ-7006	SUPPORT, BUCKET
15	1	HG18EZ-8005	SUPPORT, SCREEN
16	1	HG18EZ-8017	GLAZE KETTLE WELDMENT

DIAGRAM: HG24-2014

USE ONLY FOR

**MODEL: HG24C**

**ITEM NUMBER: 22534**

TO IDENTIFY MODEL AND ITEM NUMBER  
SEE DATA TAG ON GLAZER

BILL OF MATERIAL			
ITEM	QTY	PART NUMBER	DESCRIPTION
1	4	905-0054-1.25	END CAP, PLASTIC
2	4	FT6-0120	CASTER SOCKET; 18 GA, 1.25, RT-POLY
3	2	HG18-0031-4	SWIVEL CASTER, 4"
4	2	HG18-0031B-4	SWIVEL CASTER W/BRAKE, 4"
5	1	HG18-0527	ASSY; GLAZE APPLICATOR
6	1	HG18-7011	GLAZE DIVERTER
7	1	HG18-9001	LOW- PRESSURE CPVC BALL VALVE
8	REF	HG24-0010	KETTLE COVER
9	1	HG24-8002	SUPPORT, SCREEN
10	1	HG24-8003	KETTLE
11	1	HG24EZ-0540	FRAME WELDMENT

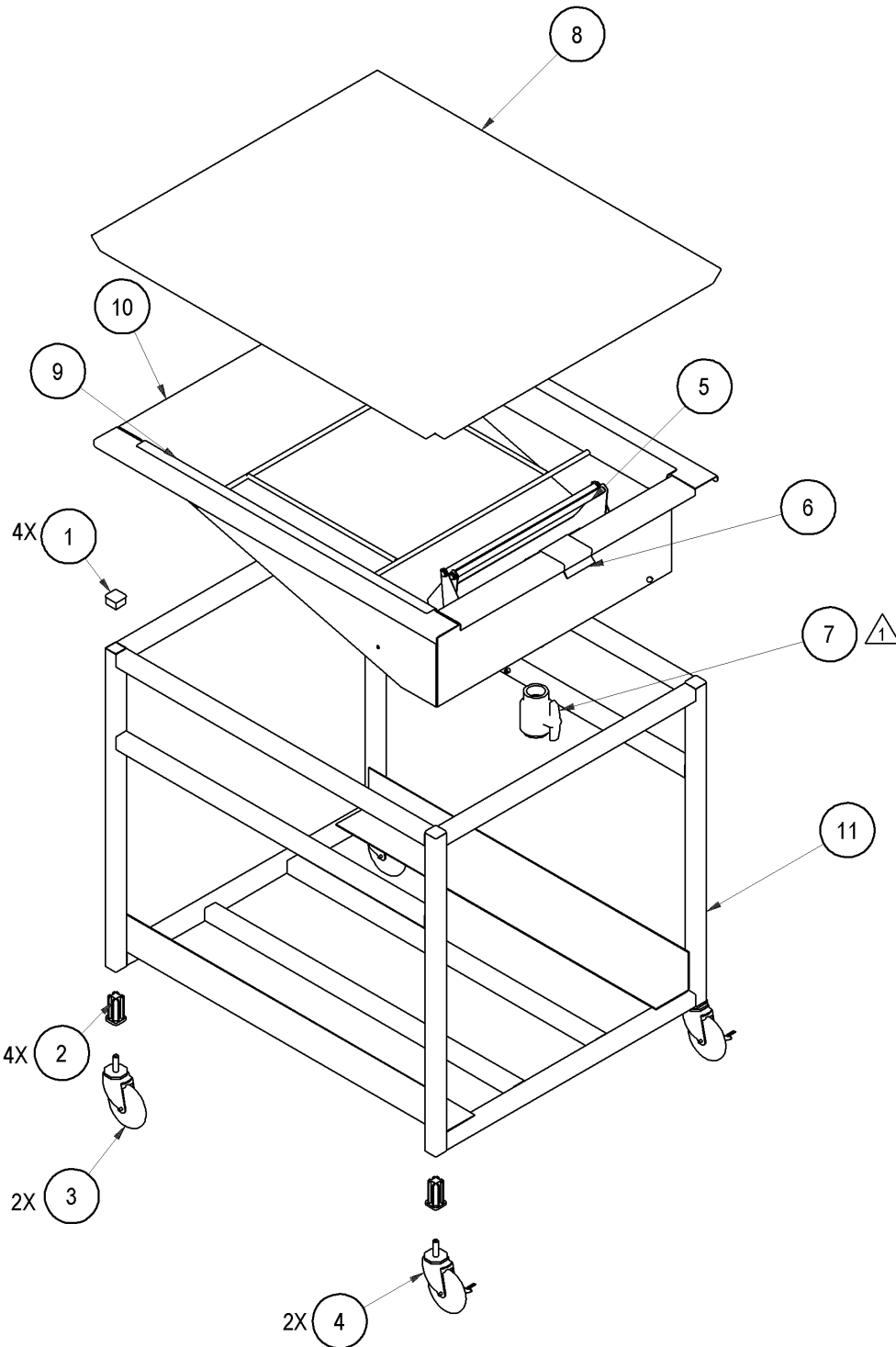

DIAGRAM: HG24EZ-2012

USE ONLY FOR

**MODEL: HG24EZ**

**ITEM NUMBER: 22536**

TO IDENTIFY MODEL AND ITEM NUMBER  
SEE DATA TAG ON GLAZER

ITEM	QTY	PART NUMBER	DESCRIPTION
1	4	905-0054-1.25	END CAP, PLASTIC
2	4	FT6-0120	CASTER SOCKET; 18 GA, 1.25, RT-POLY
3	2	HG18-0031-4	SWIVEL CASTER, 4"
4	2	HG18-0031B-4	SWIVEL CASTER W/BRAKE, 4"
5	1	HG18-9001	LOW- PRESSURE CPVC BALL VALVE
6	1	HG18EZ-0042	GLAZE DIVERTER
7	REF	HG24-0010	KETTLE COVER
8	1	HG24-8003	KETTLE
9	1	HG24EZ-0534	DRAIN TRAY ASSEMBLY, SIDE MOUNT
10	1	HG24EZ-0540	FRAME WELDMENT
11	1	HG24EZ-0543	FRAME, UPPER
12	1	HG24EZ-1000	APPLICATOR, GLAZE, ANGLE GATE
13	1	HG24EZ-8000	SUPPORT, SCREEN

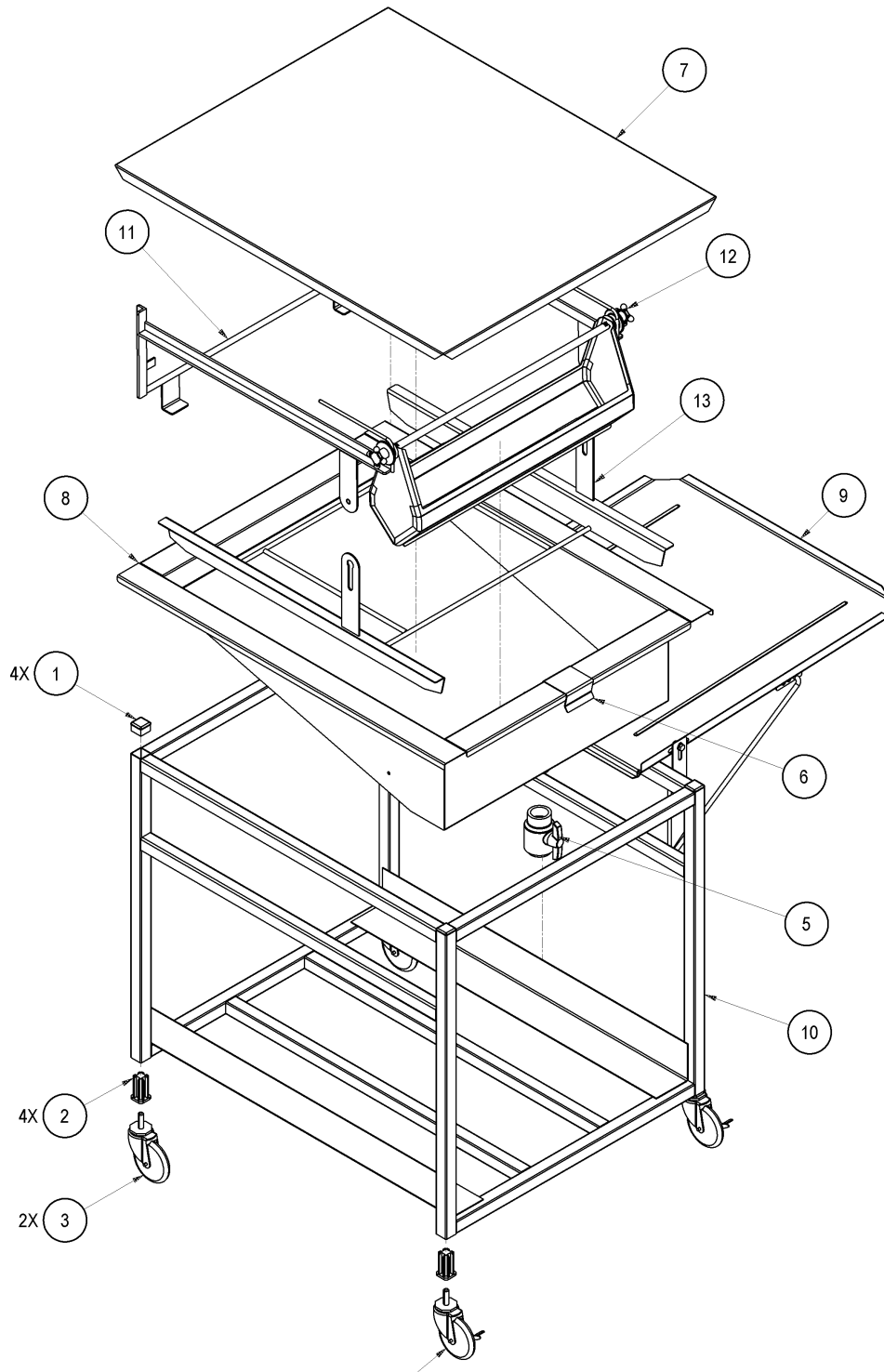

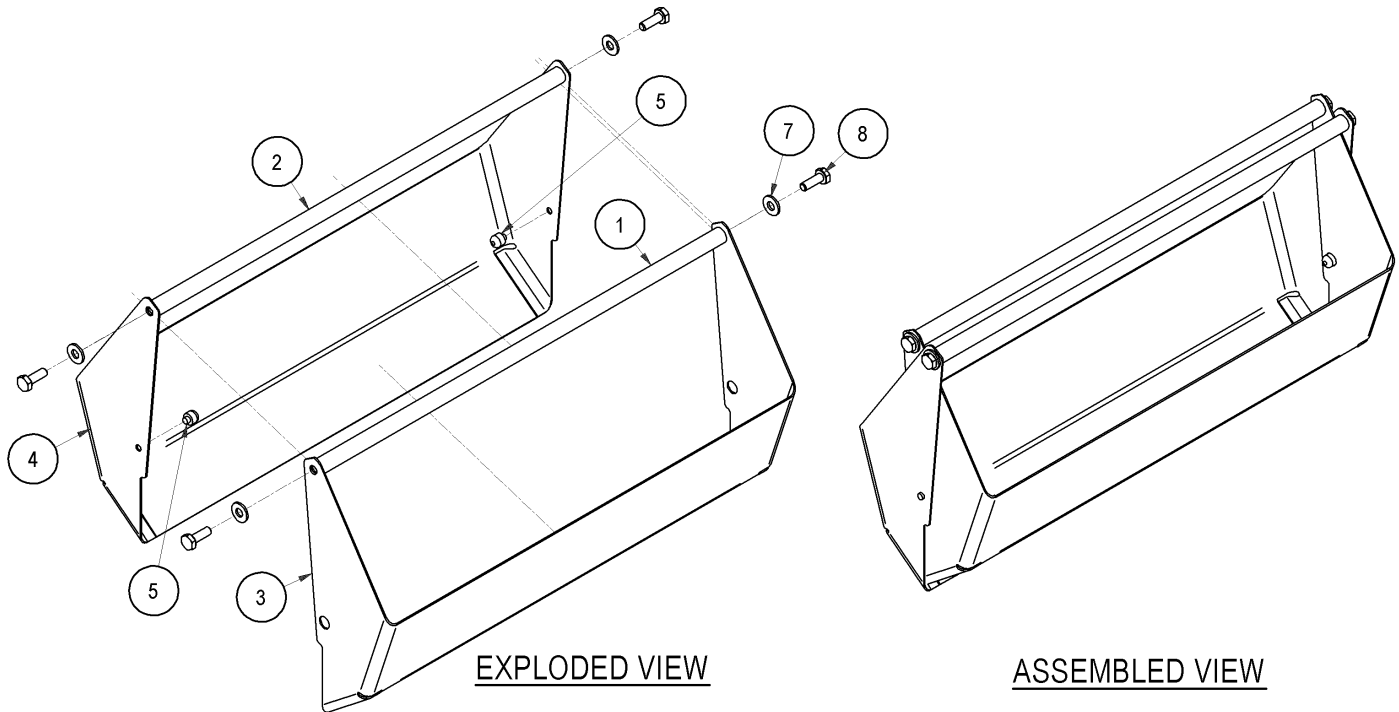

DIAGRAM: HG18-0527  
 USE ONLY FOR

**MODELS: HG18C, HG24C**

**ITEM NUMBERS: 22528, 22534**

TO IDENTIFY MODEL AND ITEM NUMBER, SEE DATA TAG ON GLAZER



EXPLODED VIEW

ASSEMBLED VIEW

BILL OF MATERIAL			
ITEM	QTY	PART NUMBER	DESCRIPTION
1	1	HG18-0088	HANDLE; GLAZE APPLICATOR-INNER SHELL
2	1	HG18-0087	HANDLE; GLAZE APPLICATOR-OUTER SHELL
3	1	HG18-0086	GLAZE APPLICATOR SIDE-INNER SHELL
4	1	HG18-0085	GLAZE APPLICATOR SIDE-OUTER SHELL
5	2	HG18-0003	HINGE STUD
7	4	903-7531SS	SST, 1/4 FLAT WASHER, REGULAR
8	4	--	SST, 1/4-20 X 0.75 HEX HEAD MACHINE SCREW

DIAGRAM: HG18EZ-1004

USE ONLY FOR

**MODELS: HG18EZ**

**ITEM NUMBERS: 22529, 22530**

TO IDENTIFY MODEL AND ITEM NUMBER, SEE DATA TAG ON GLAZER

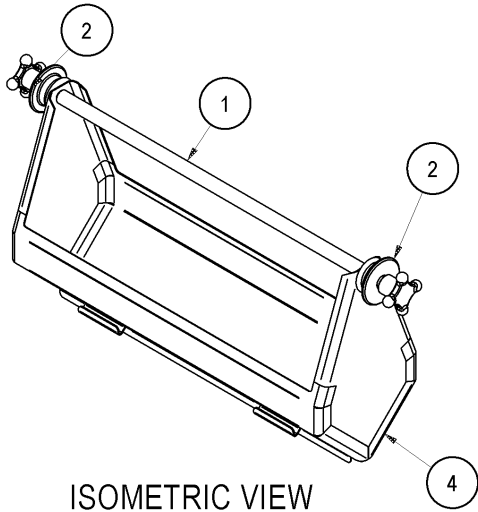

ISOMETRIC VIEW  
SCALE 1:6

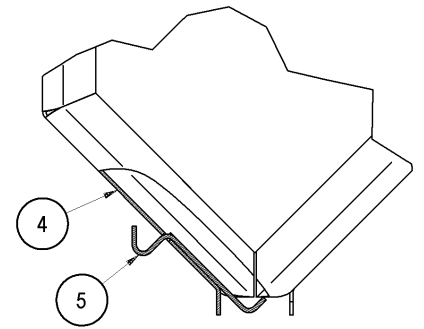

DETAIL B  
SCALE 1:2 

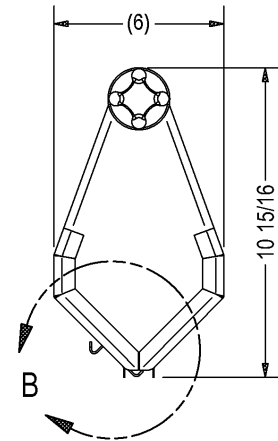
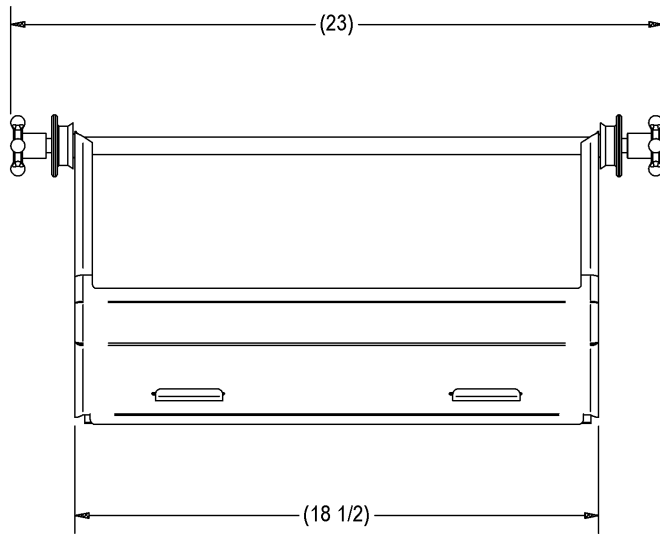

BILL OF MATERIAL				
ITEM	QTY	PART NUMBER	DESCRIPTION	
1	1	HG18EZ-0033	MAIN SHAFT	
2	2	HG18EZ-0057	GLAZER ROLLER	
3	2	HG18EZ-0527	CLAMPING KNOB, 1/2-13 THREAD	
4	1	HG18EZ-0536	GLAZE APPLICATOR WELDMENT	
5	1	HG18EZ-7012	GATE, ANGLE, 11/32"	

DIAGRAM: HG18EZ-1007

USE ONLY FOR

**MODELS: HG18EZ**

**ITEM NUMBERS: 22569, 22569-1**

TO IDENTIFY MODEL AND ITEM NUMBER, SEE DATA TAG ON GLAZER

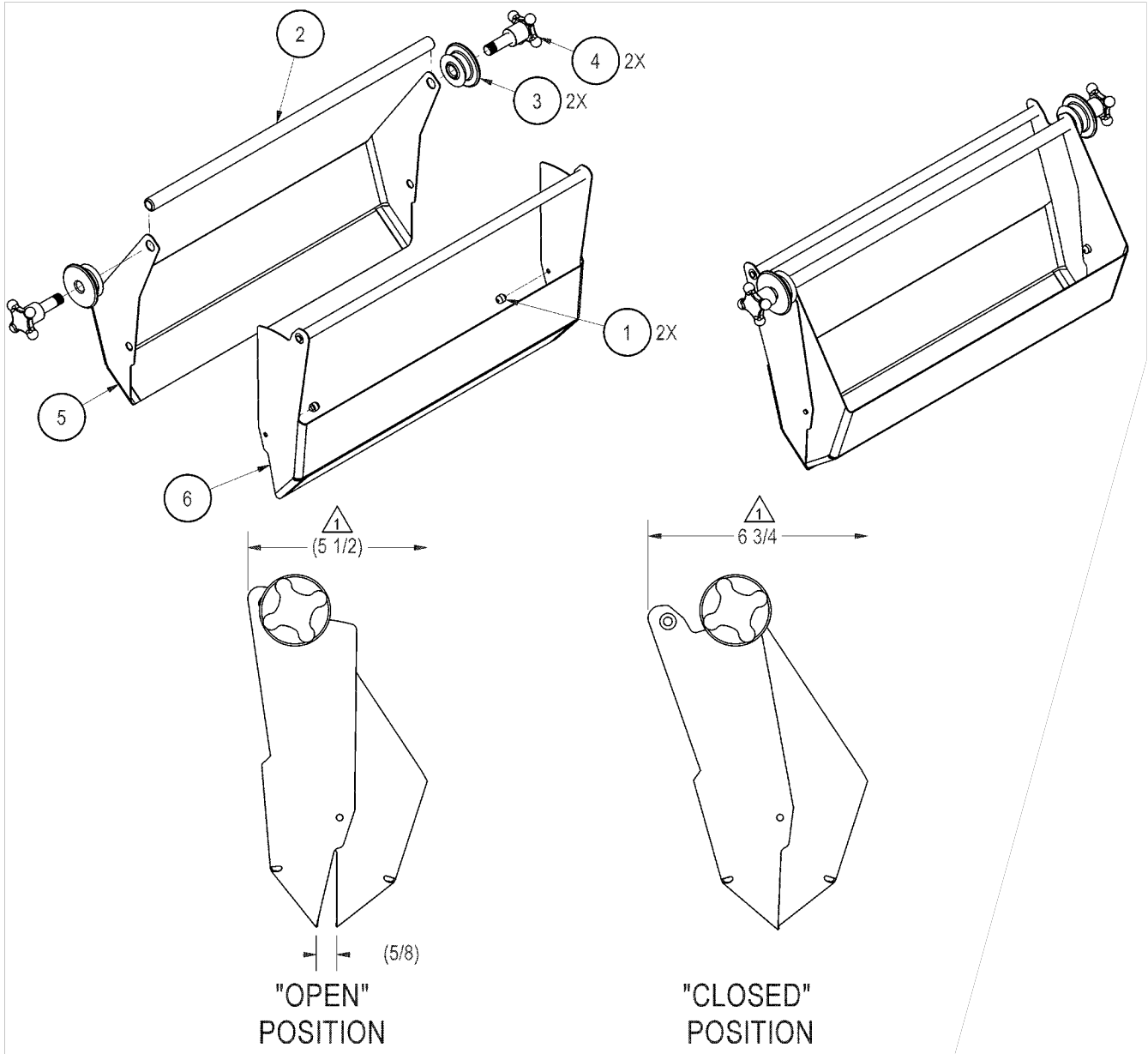

ITEM	QTY	PART NUMBER	DESCRIPTION
1	2	HG18-0003	HINGE STUD
2	1	HG18EZ-0033	MAIN SHAFT
3	2	HG18EZ-0057	GLAZER ROLLER
4	2	HG18EZ-0527	CLAMPING KNOB, 1/2-13 THREAD
5	1	HG18EZ-7031	GLAZE APPLICATOR, ADJUSTABLE FLOW, SIDE-INNER SHELL
6	1	HG18EZ-8020	GLAZE APPLICATOR, ADJUSTABLE FLOW, SIDE-OUTER SHELL, WLDT

DIAGRAM: HG24EZ-1000

USE ONLY FOR

**MODELS: HG24EZ**

**ITEM NUMBERS: 22536**

TO IDENTIFY MODEL AND ITEM NUMBER, SEE DATA TAG ON GLAZER

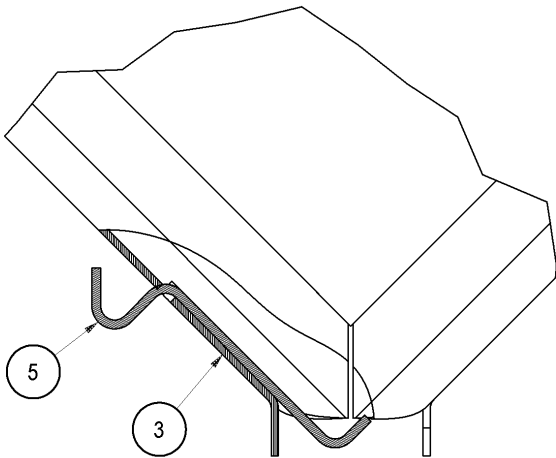

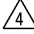
DETAIL B  SCALE 1 / 1

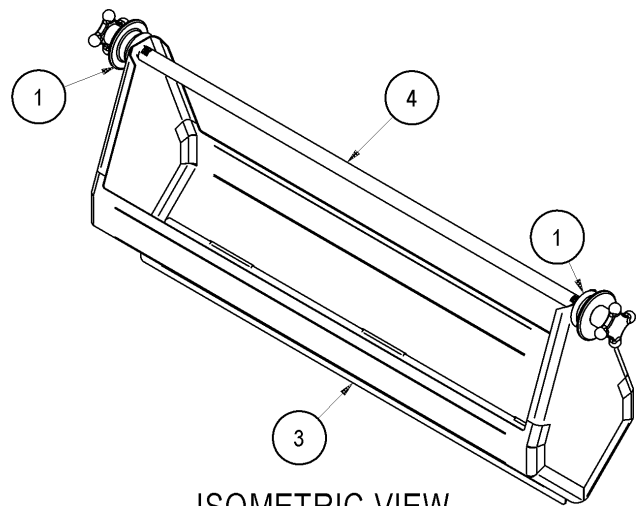

ISOMETRIC VIEW

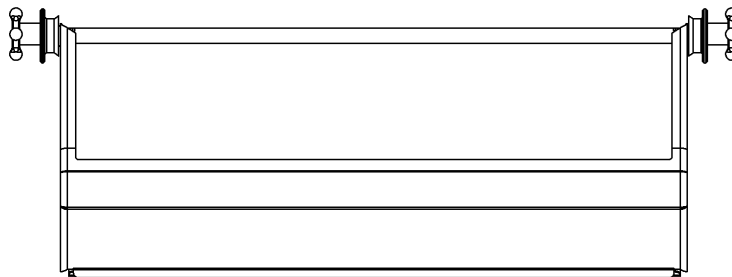
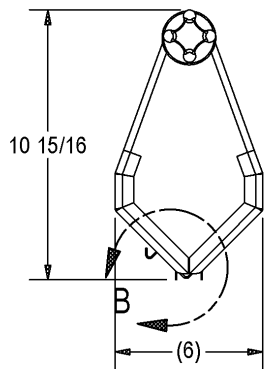

BILL OF MATERIAL			
ITEM	QTY	PART NUMBER	DESCRIPTION
1	2	HG18EZ-0057	GLAZER ROLLER
2	2	HG18EZ-0527	CLAMPING KNOB, 1/2-13 THREAD
3	1	HG24EZ-0542	GLAZE APPLICATOR WELDMENT
4	1	HG24EZ-6000	MAIN SHAFT
5	1	HG24EZ-7003	GATE, ANGLE, 11/32"

DIAGRAM: HG18EZ-1002 USE ONLY FOR

**MODELS: HG18C, HG18EZ**

**ITEM NUMBERS:**

**22528, 22529, 22530, 22569, 22569-1**

TO IDENTIFY MODEL AND ITEM NUMBER, SEE DATA TAG ON GLAZER

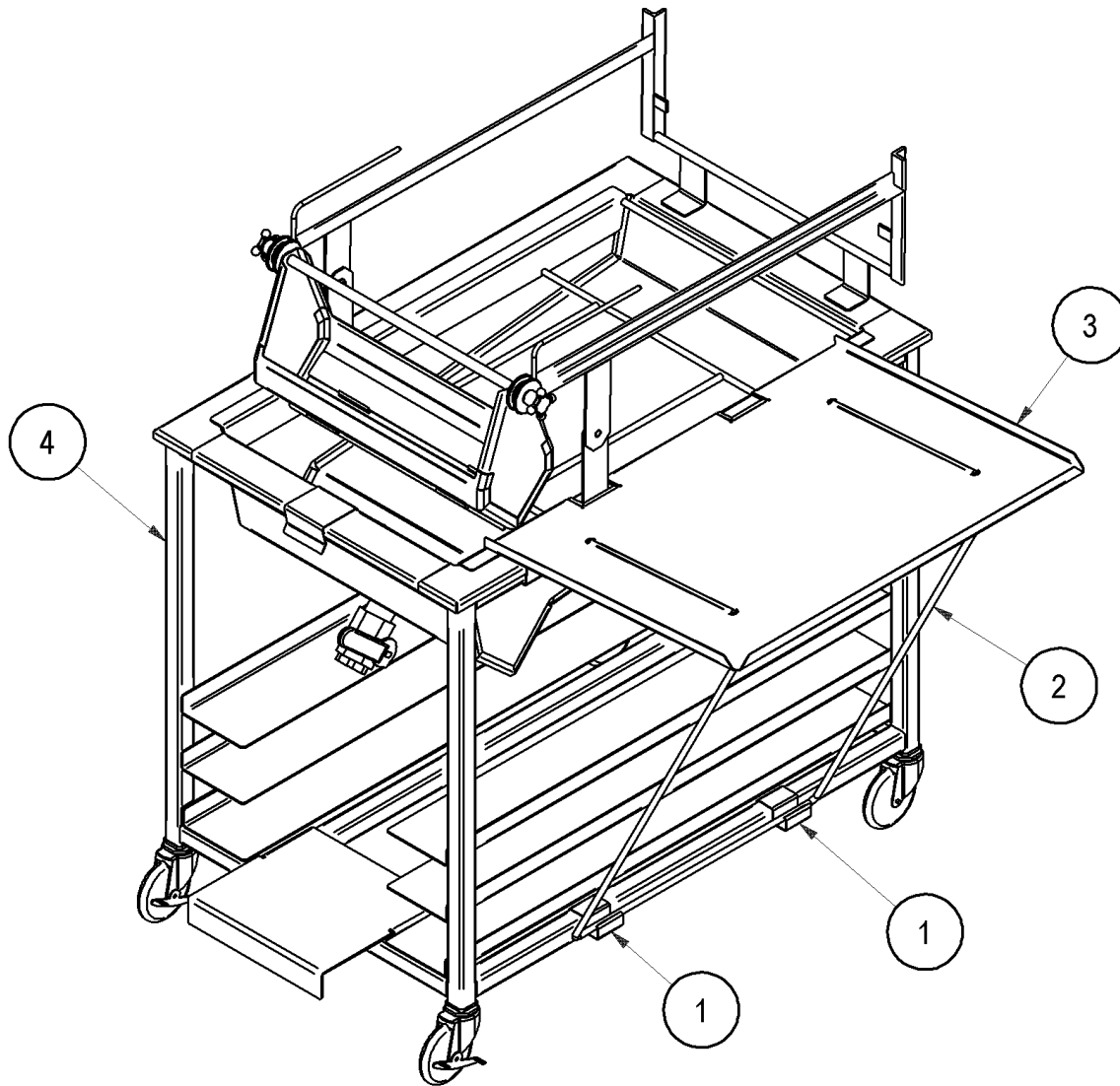

1 BILL OF MATERIAL			
ITEM	QTY	PART NUMBER	DESCRIPTION
1	2	HG18-0042	DRAIN TRAY SUPT BRKT
2	1	HG18EZ-6002	ROD, SUPPORT, DRAIN TRAY
3	1	HG18EZ-8004	TRAY, DRAIN
4	1	REF	GLAZER

DIAGRAM: HG18EZ-1003 USE ONLY FOR

**MODELS: HG18C, HG18EZ**

**ITEM NUMBERS:**

**22528, 22529, 22530, 22569, 22569-1**

TO IDENTIFY MODEL AND ITEM NUMBER, SEE DATA TAG ON GLAZER

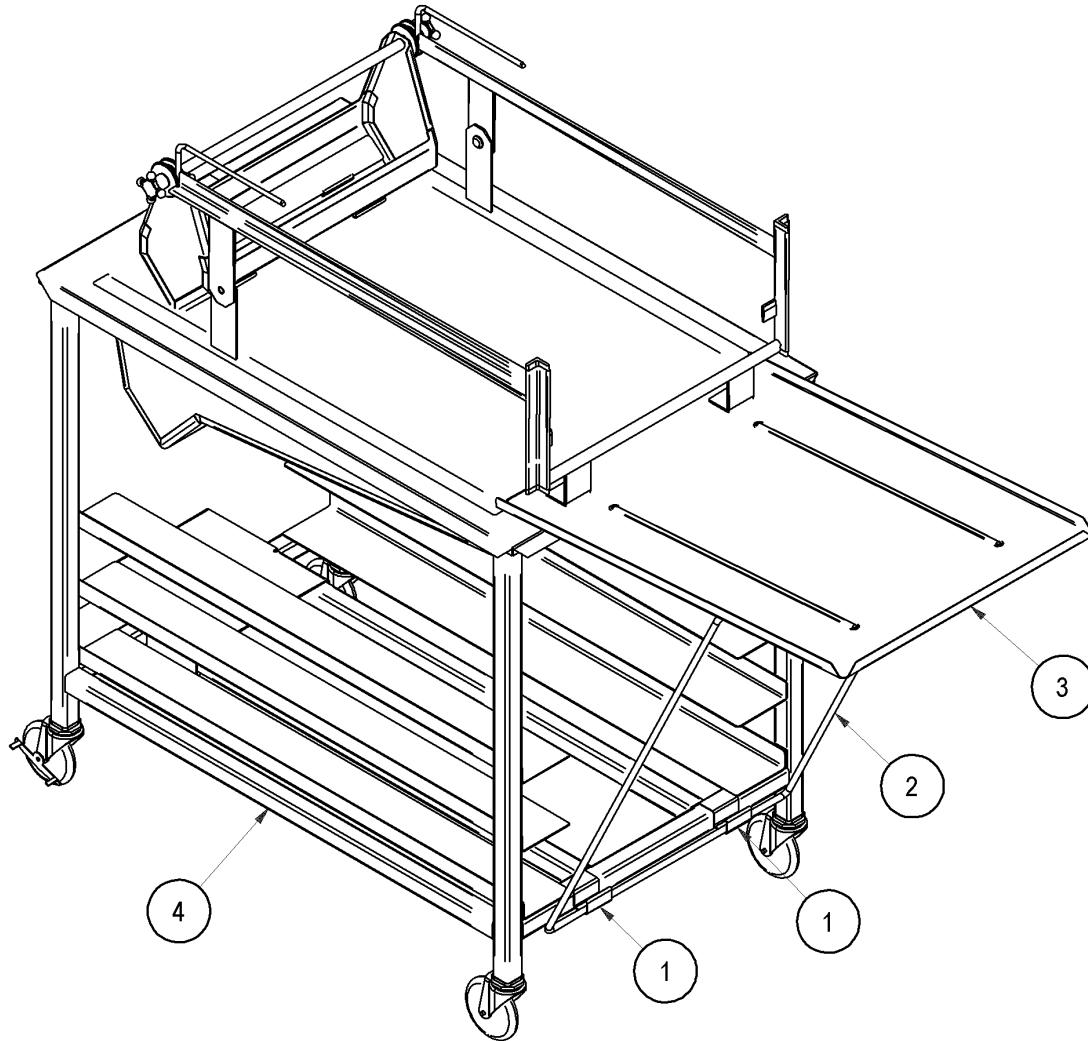

BILL OF MATERIAL

ITEM	QTY	PART NUMBER	DESCRIPTION
1	2	HG18-0042	DRAIN TRAY SUPT BRKT
2	1	HG18EZ-6002	ROD, SUPPORT, DRAIN TRAY
3	1	HG18EZ-8007	TRAY, DRAIN, END
4	1	REF	GLAZER

DIAGRAM: HG24EZ-1002 USE ONLY FOR

**MODELS: HG24C, HG24EZ**

**ITEM NUMBERS:**

**22534, 22536**

TO IDENTIFY MODEL AND ITEM NUMBER, SEE DATA TAG ON GLAZER

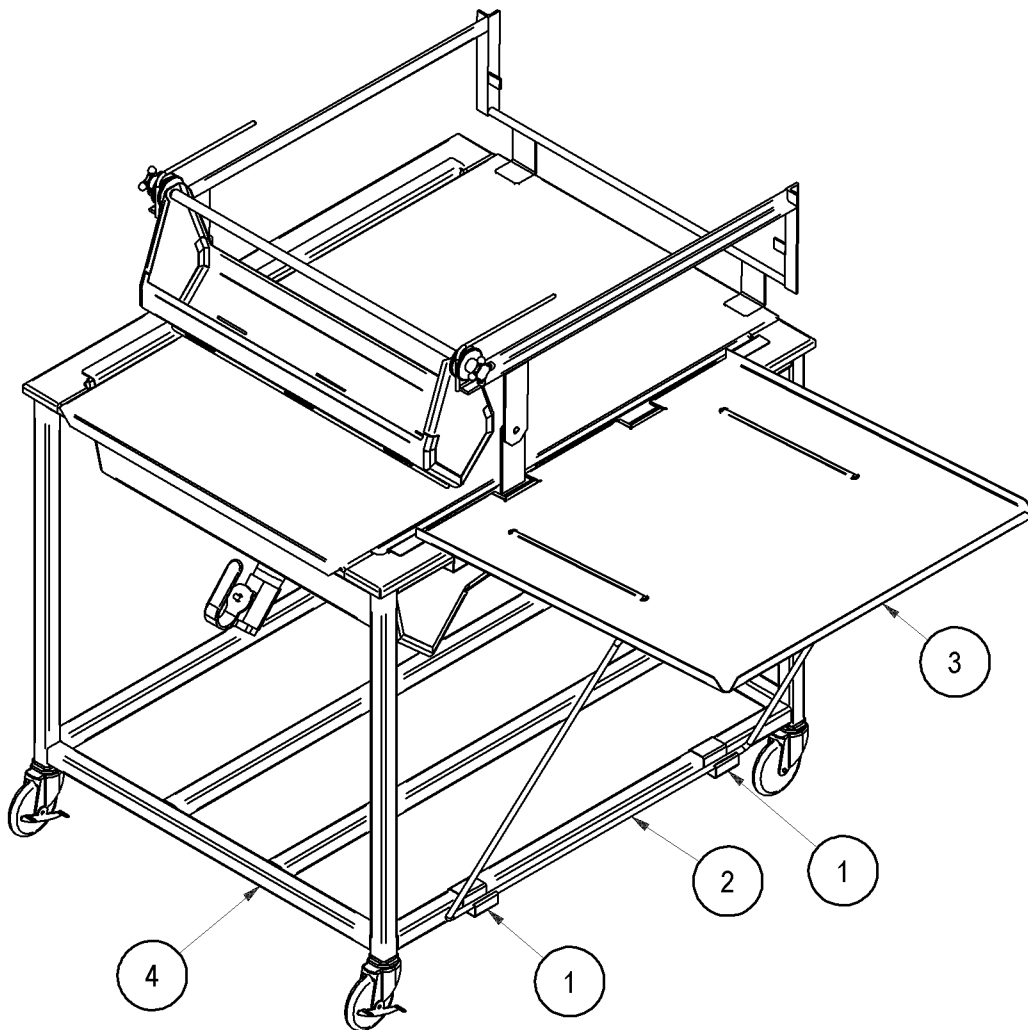

BILL OF MATERIAL

ITEM	QTY	PART NUMBER	DESCRIPTION
1	2	HG18-0042	DRAIN TRAY SUPT BRKT
2	1	HG24EZ-6001	ROD, SUPPORT, DRAIN TRAY
3	1	HG24EZ-8001	TRAY, DRAIN, SIDE
4	1	REF	GLAZER

DIAGRAM: HG24EZ-1003 USE ONLY FOR

**MODELS: HG24C, HG24EZ**

**ITEM NUMBERS:**

**22534, 22536**

TO IDENTIFY MODEL AND ITEM NUMBER, SEE DATA TAG ON GLAZER

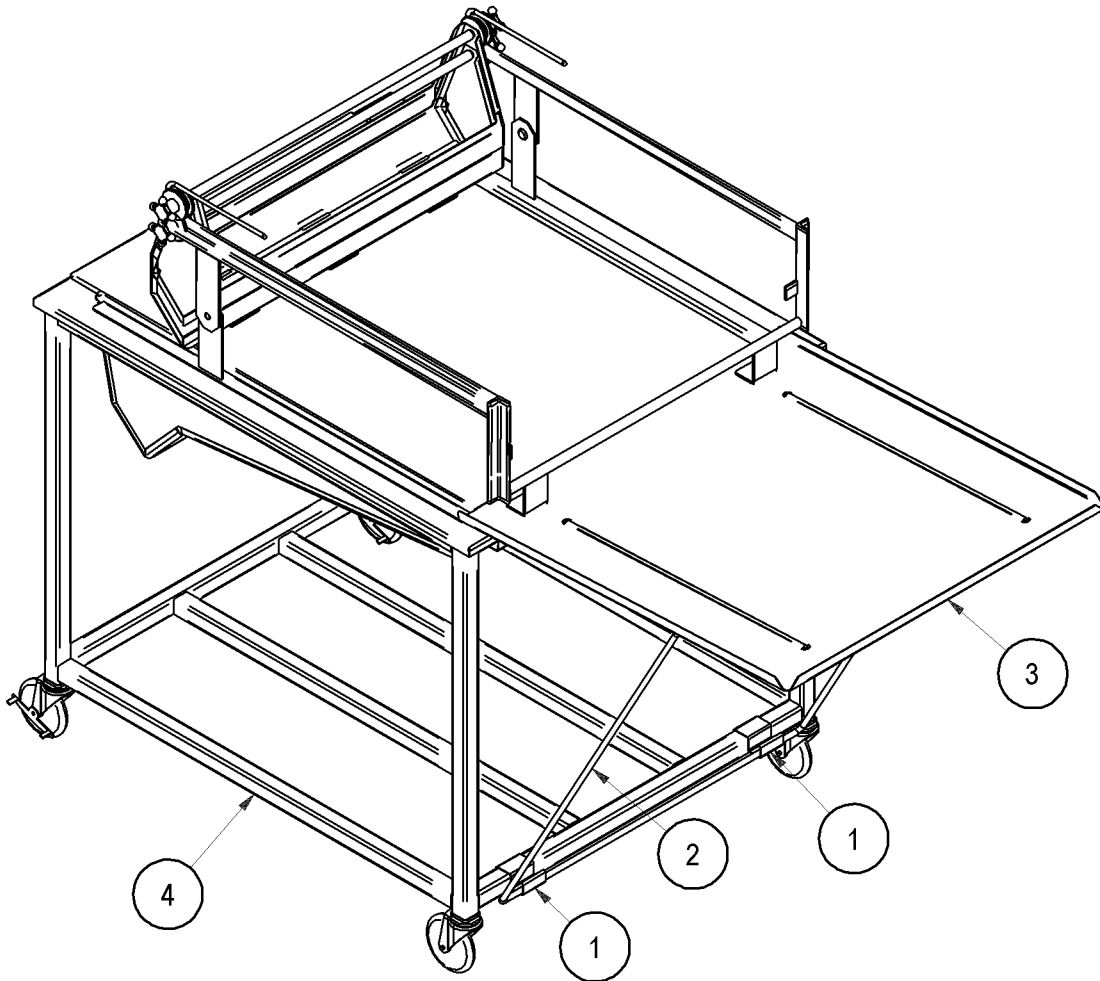

BILL OF MATERIAL

ITEM	QTY	PART NUMBER	DESCRIPTION
1	2	HG18-0042	DRAIN TRAY SUPT BRKT
2	1	HG24EZ-6001	ROD, SUPPORT, DRAIN TRAY
3	1	HG24EZ-8002	TRAY, DRAIN, END
4	1	REF	GLAZER